



**LocalLe**  
EVENTS & SOUL



Torre  
Emperador  
Castellana



Torre  
Emperador  
Castellana

Torre Emperador Castellana 259D

259D



# TORRE EMPERADOR CASTELLANA LIFTS YOUR EVENTS



This building is one of the highest skyscrapers in Spain, with a height of **235 meters** distributed **in 57 floors** coated with a double façade system, for a thermic and light conditioning isolation of the highest quality.

**A unique building, with a sustainable design which prioritizes power efficiency.**

- 1 LOCATION
- 2 ACCESSIBILITY
- 3 PANORAMIC VIEWS
- 4 RANGE OF SPACES
- 5 VERSATILITY
- 6 SECURITY
- 7 PRIVACY



## Committed to sustainability Guaranteed by the BREEAM certificate

Torre Emperador Castellana has been **certified for “Excellence” and “Exceptional”** by the **BREEAM® ES certificate**. This certificate is internationally recognised and is in charge of evaluating buildings and facilities in accordance to the environment and their sustainability.

In addition to looking after the ecosystem, the BREEAM certificate recognizes the commitment of Torre Emperador Castellana with the population's health and well-being.

### BREEAM STANDARDS

- 1 HEALTH AND WELL-BEING
- 2 ENERGY
- 3 TRANSPORT
- 4 WATER
- 5 RESOURCES
- 6 RESILIENCE
- 7 USE OF LAND AND ECOLOGY
- 8 POLLUTION



# AVAILABLE AREAS FOR EVENTS

## FLOORS

- **12th FLOOR** floor and semifloor
- **47th FLOOR** floor and semifloor
- **48th FLOOR** floor

## MEETING ROOMS

- **18th FLOOR** rooms from 6 to 50 guests
- **33rd FLOOR** rooms from 6 to 12 guests

## RESTAURANT

- **33rd FLOOR** Élkar



# FLOORS

FLOOR 0  
12th FLOOR  
47th FLOOR  
48th FLOOR

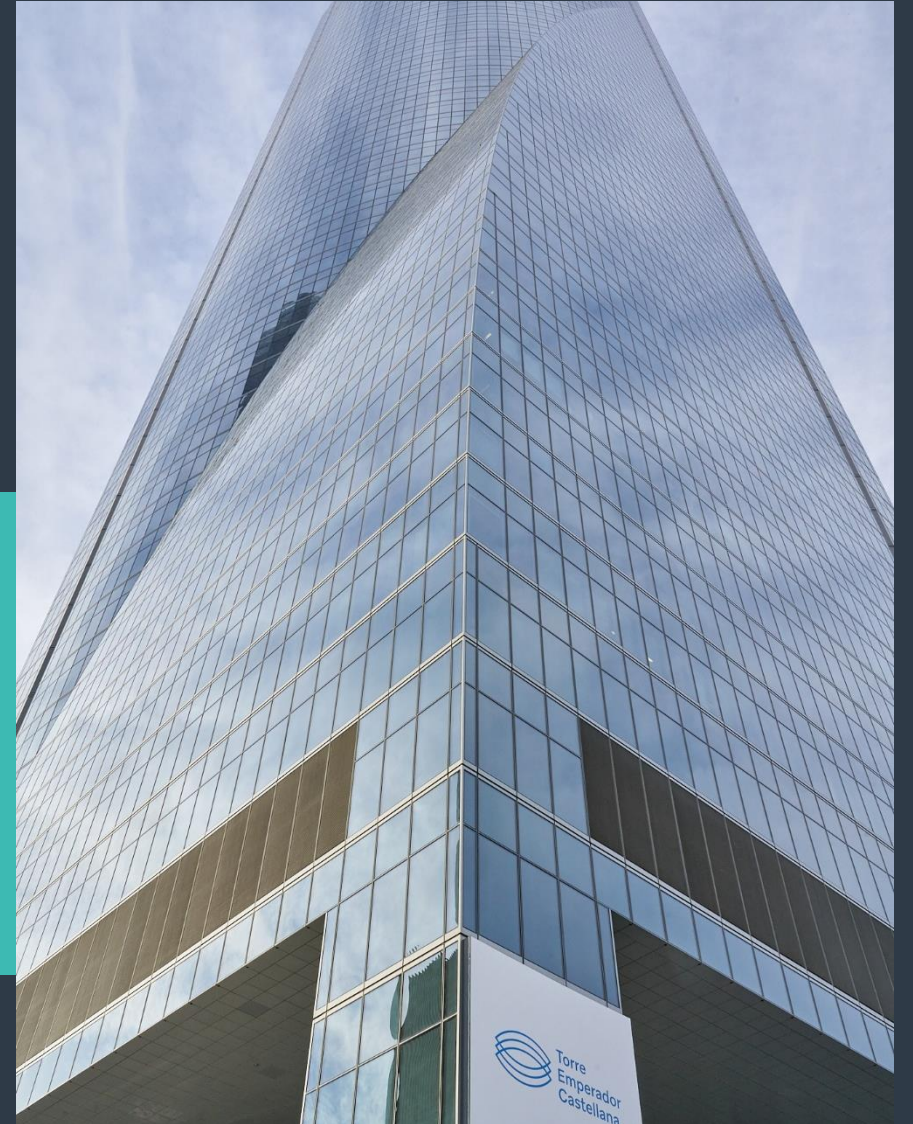





# FORMATS





# FORMATS

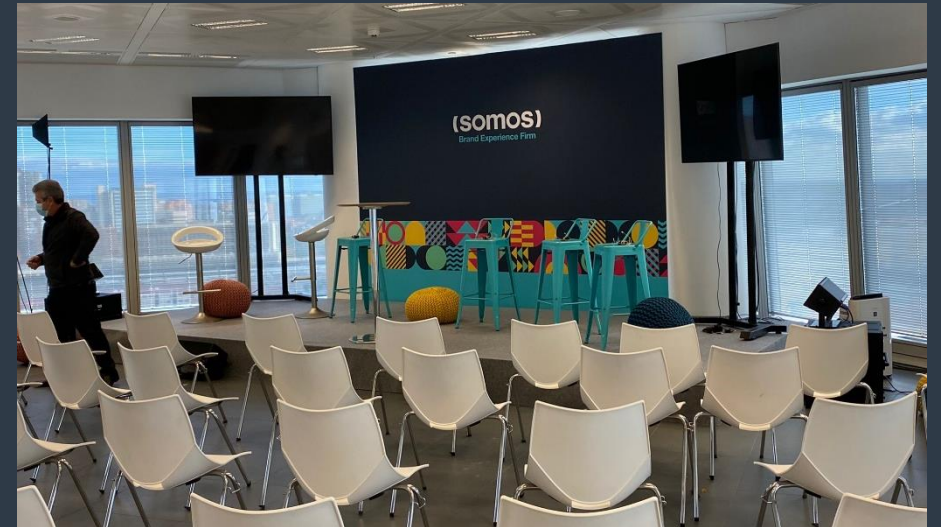
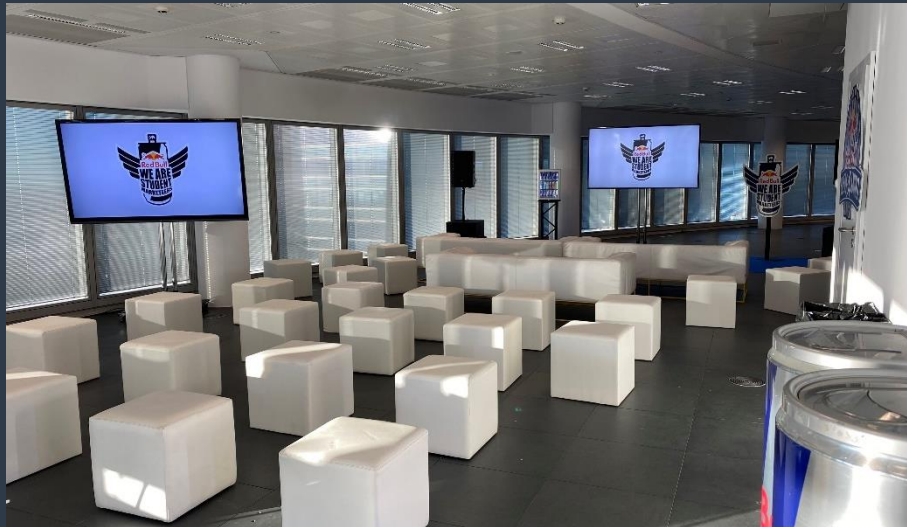







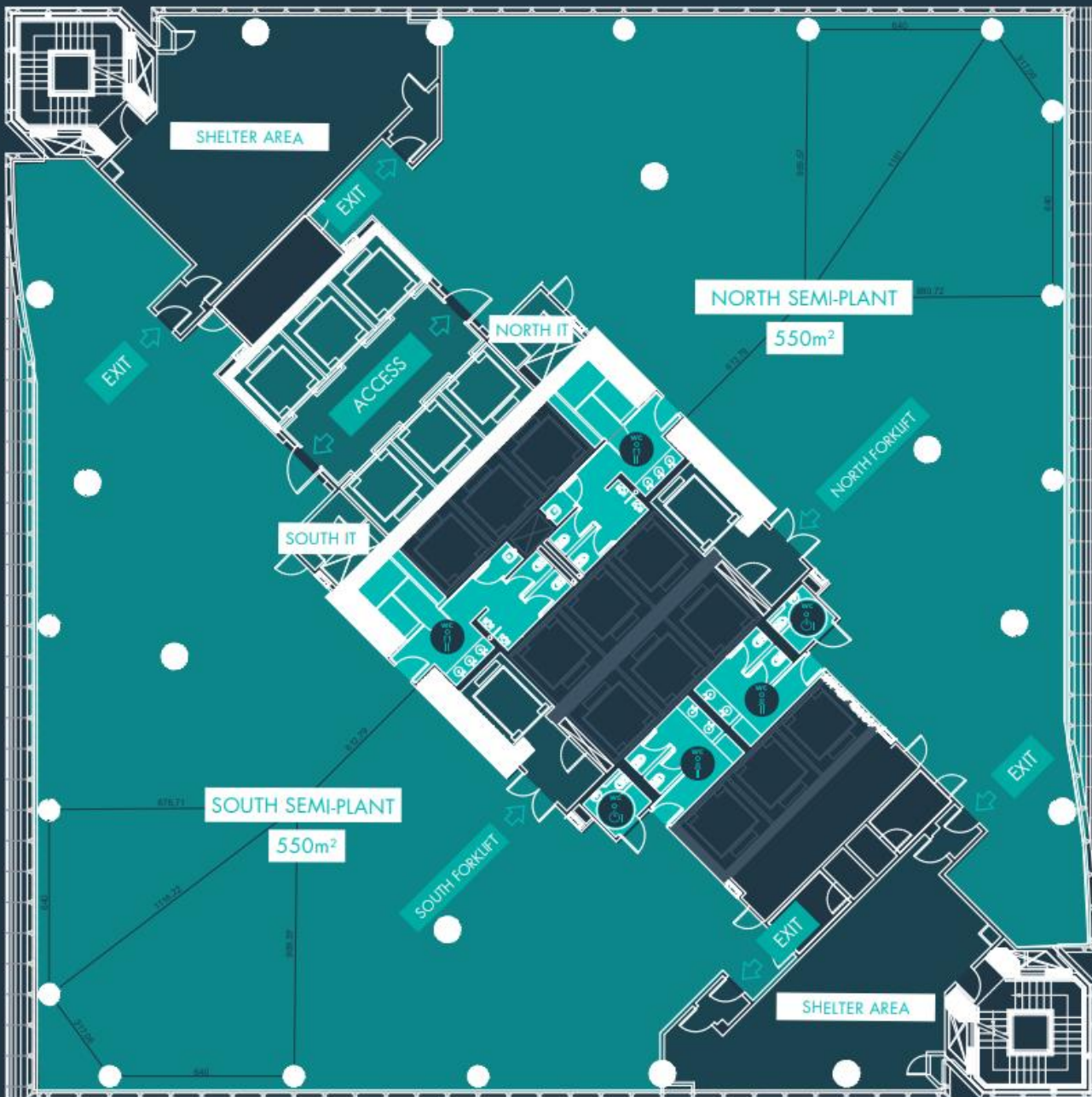

## PLANTA 12

	SEMIPLANTA NORTE	SEMIPLANTA SUR
AFORO	90PAX	90PAX
SUPERFICIE	532m2	532m2

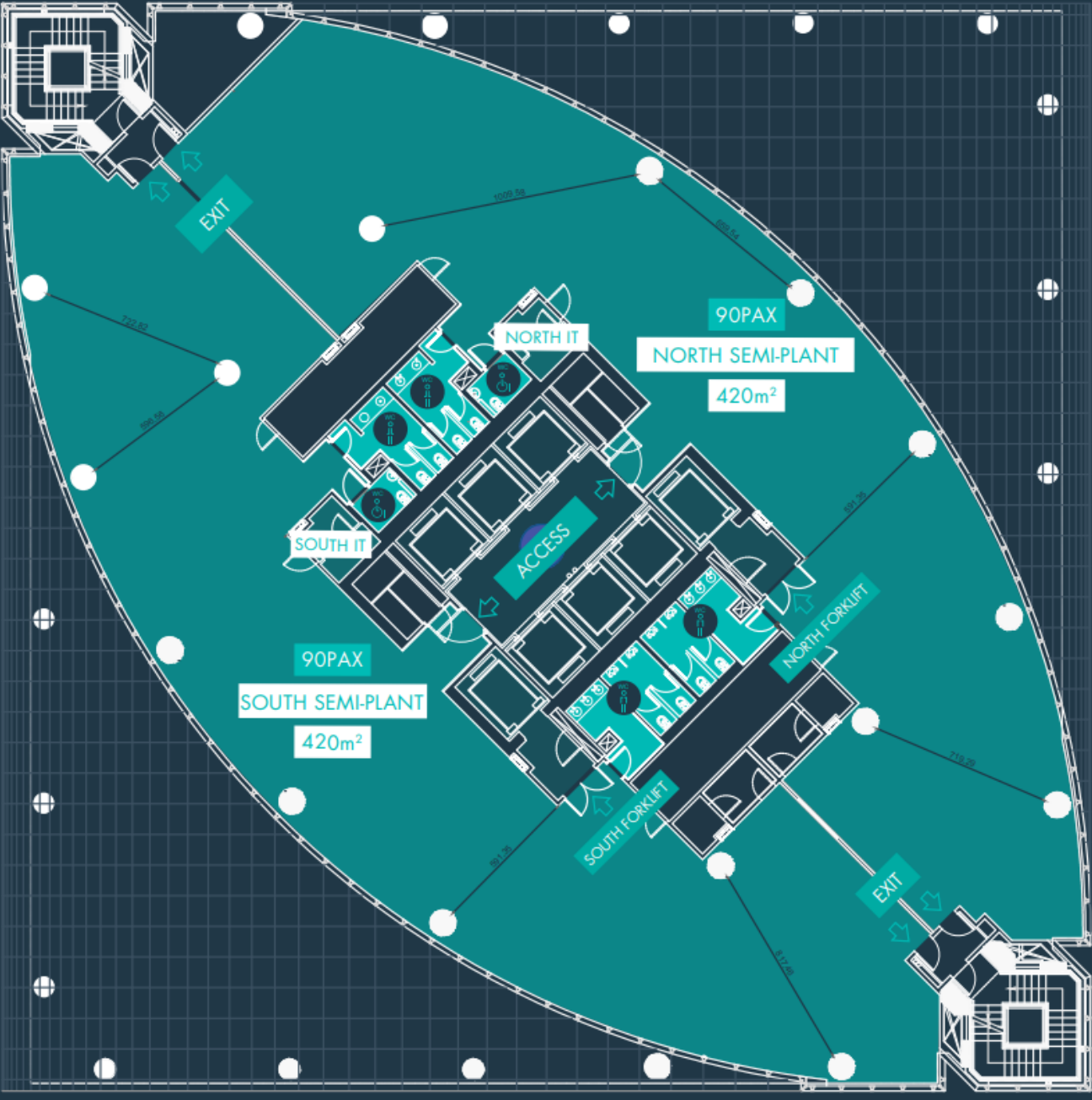

PLANTA 47

	SEMIPLANTA NORTE	SEMIPLANTA SUR
AFORO	90PAX	90PAX
SUPERFICIE	420m2	420m2





## PLANTA 48

	PLANTA COMPLETA
AFORO	180-200PAX
SUPERFICIE	840m2



## PLANTA 0

	SEMIPLANTA NORTE
AFORO	90PAX
SUPERFICIE	840m2



# EVENTS





# EVENTS





# MEETING ROOMS

18th FLOOR  
33rd FLOOR

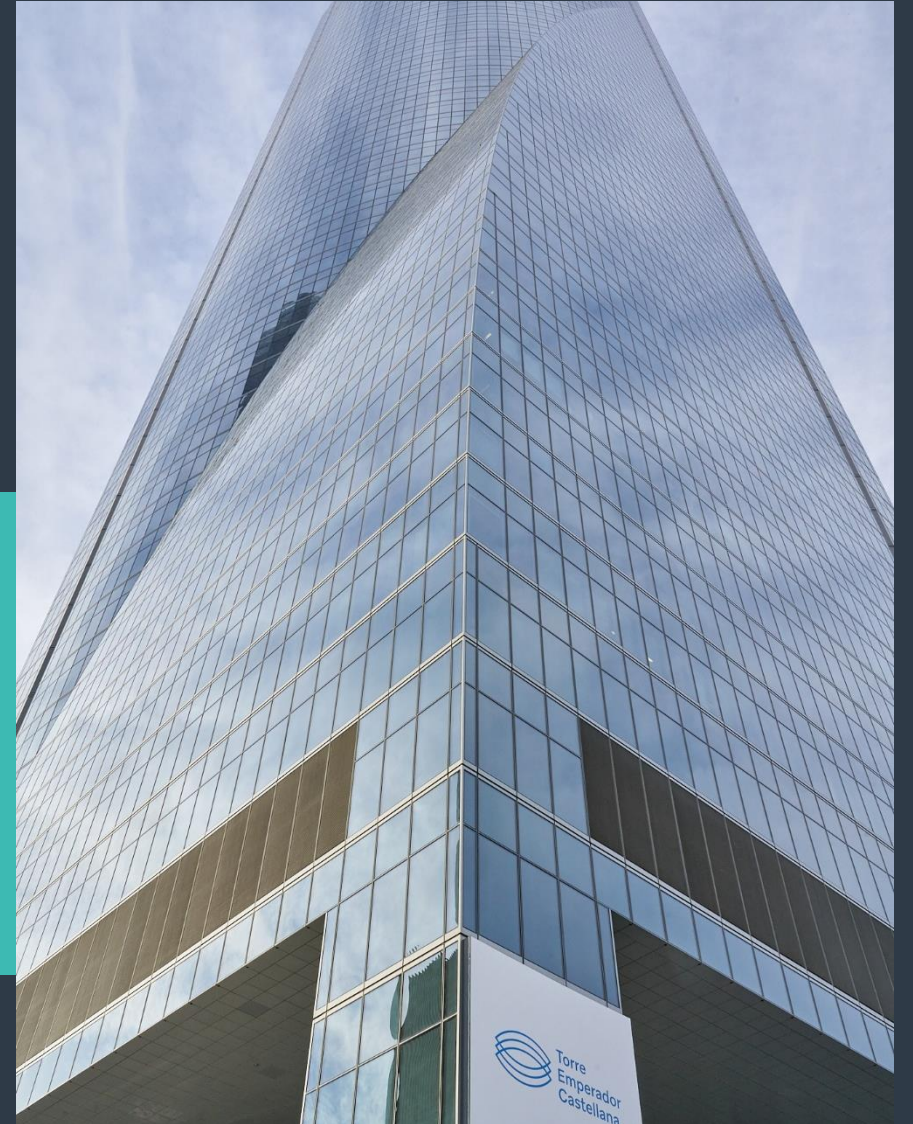

# 18th FLOOR

Events:  
from 6 to 45 guests





# 18th FLOOR: ÁGORA

Unique presentations



- The Ágora is an area for special presentations, it can accommodate from conferences to photographic and film shootings. Located in an illuminated and spacious environment, it can hold up to 25 people.
- 86" Touch Screen
- 47m2 Surface



## 18th FLOOR: MULTIFORMAT ROOMS

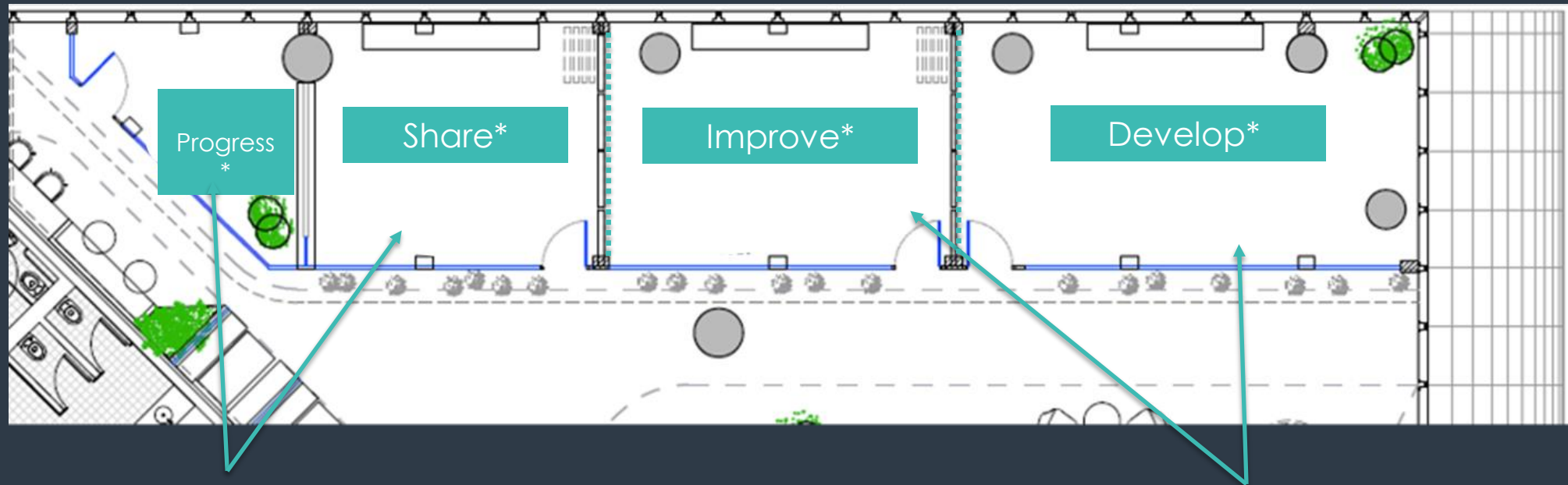

55" Screen with HDMI connection and sound bar.

86" Touch Screen with HDMI connection and sound bar.

\*Multifunction rooms combinable with retractable panels





## 18th FLOOR: OTHER SET UP`S MULTIFORMAT ROOMS

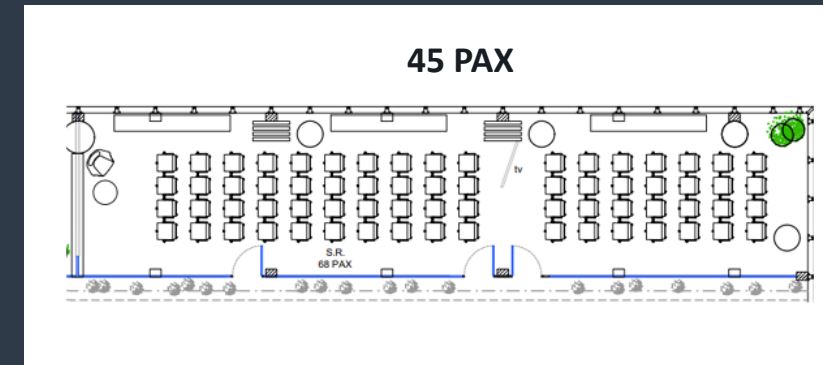
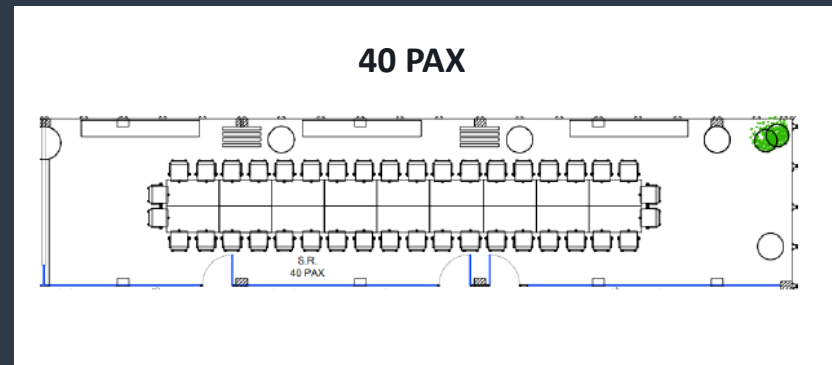
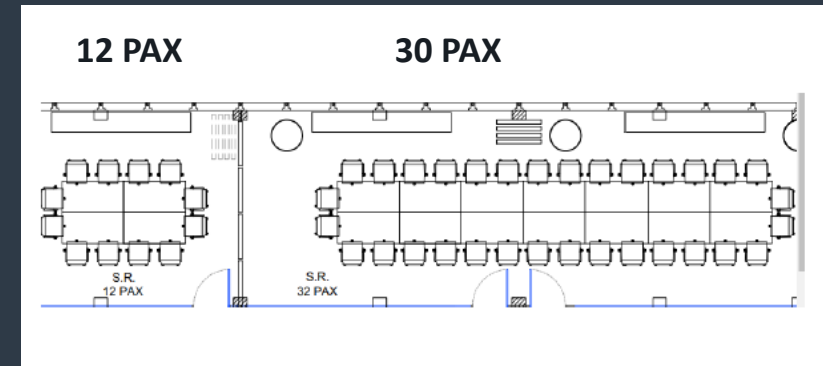
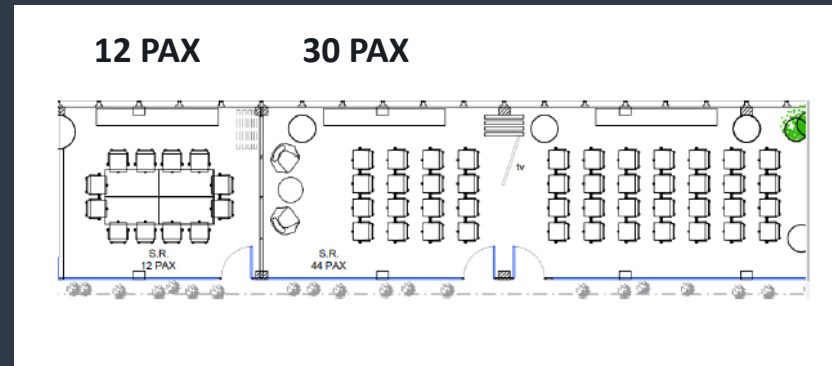



## 33rd FLOOR

Events and  
meetings:  
from 4 to 12  
guests

- 5 Rooms with total privacy for meetings, lunches and dinners.
- Capacity from 4 to 12 people.
- Audiovisual aid available.



Harveys		Fundador		Emperador		Garvey		Terry	
12 pax	AV	10 pax	AV	8 pax	AV	6 pax	AV under petition	8 pax	AV under petition

# 33rd FLOOR

## Meeting Rooms





# 33rd FLOOR

## Meeting Rooms



# RESTAURANT

ÉLKAR





# ÉLKAR



Élkar restaurant is located on the 33rd floor of Torre Emperador Castellana. At 160 meters of altitude and a capacity for 70 people, this exclusive venue offers spectacular views of Madrid's Skyline. Élkar, which means together in euskera, is the new elevated vasque cuisine, which is born from the union of two great chefs. They have created a fusion between two kitchens with a lot of personality: Sergio Ortiz from Zárata, Michelin Star and specialist in sea products, and Beñat Ormaetxea, Nacional Prize Winner for Young Chefs and specialised in hunting.

The restaurant's unforgettable entrance features an open space to conduct cocktails or a wine tasting, where the guests can discover the finest qualities from the wine menu.





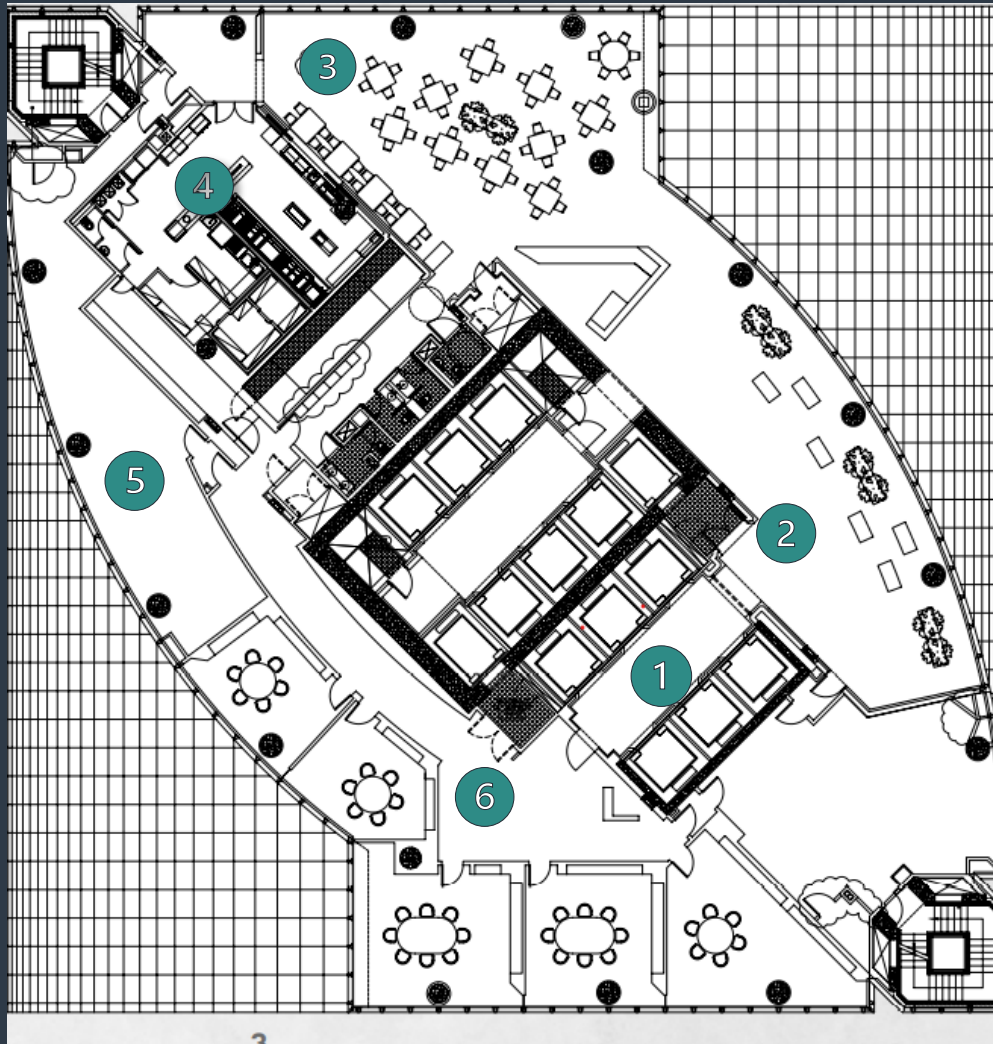

1. Elevators
2. Hall, wine tasting area
3. Restaurant
4. Kitchens
5. Refuge area
6. Private rooms

# LOCATION

Excellent accesibility:

- 7 min from Chamartín Train Station
- 20 min from Madrid Airport Barajas Adolfo Suárez
- Next to the M30

## PUBLIC TRANSPORT

### METRO



10

1

### BUS LINES

173/175/176/178/151/152C/153/67/124/134/  
135/N24



Paseo de la Castellana, 259D. 28036 Madrid



# SERVICES TORRE EMPERADOR CASTELLANA



CATERING



SECURITY



CLEANING



AUDIOVISUAL AID

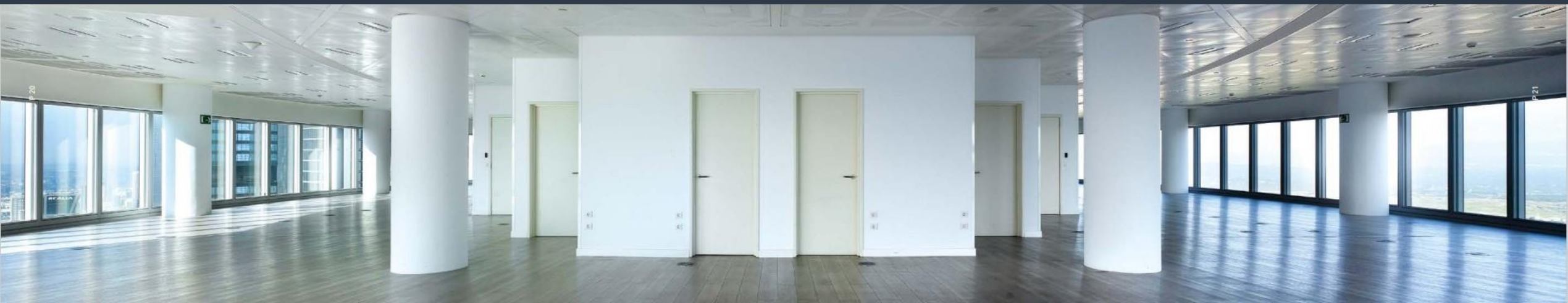

TORRE EMPERADOR CASTELLANA  
[www.torremperadorcastellana.com](http://www.torremperadorcastellana.com)



<https://www.linkedin.com/company/torre-emperador-castellana/>



@torreemperadorcastellana

**Locale**



[info@lcale.es](mailto:info@lcale.es)



+34 649 158 884



[www.lcale.es](http://www.lcale.es)